

HIGH PRESSURE PUMP (3-0144)

NOTE: ITEM 53 = (2) SET SCREWS SECURE THE PUMP SHAFT TO THE ENGINE SHAFT. IN ORDER TO REMOVE THE PUMP ASSEMBLY FROM THE ENGINE, THESE SET SCREWS MUST BE REMOVED FROM THE PUMP SHAFT THRU THE ACCESS HOLES LOCATED ON THE FLANGE OF THE PUMP ASSEMBLY

TORQUE SPEC'S	
POSITION	FT/LBS
1	4
20	4
22	3,6
42	4,4
52	9,4

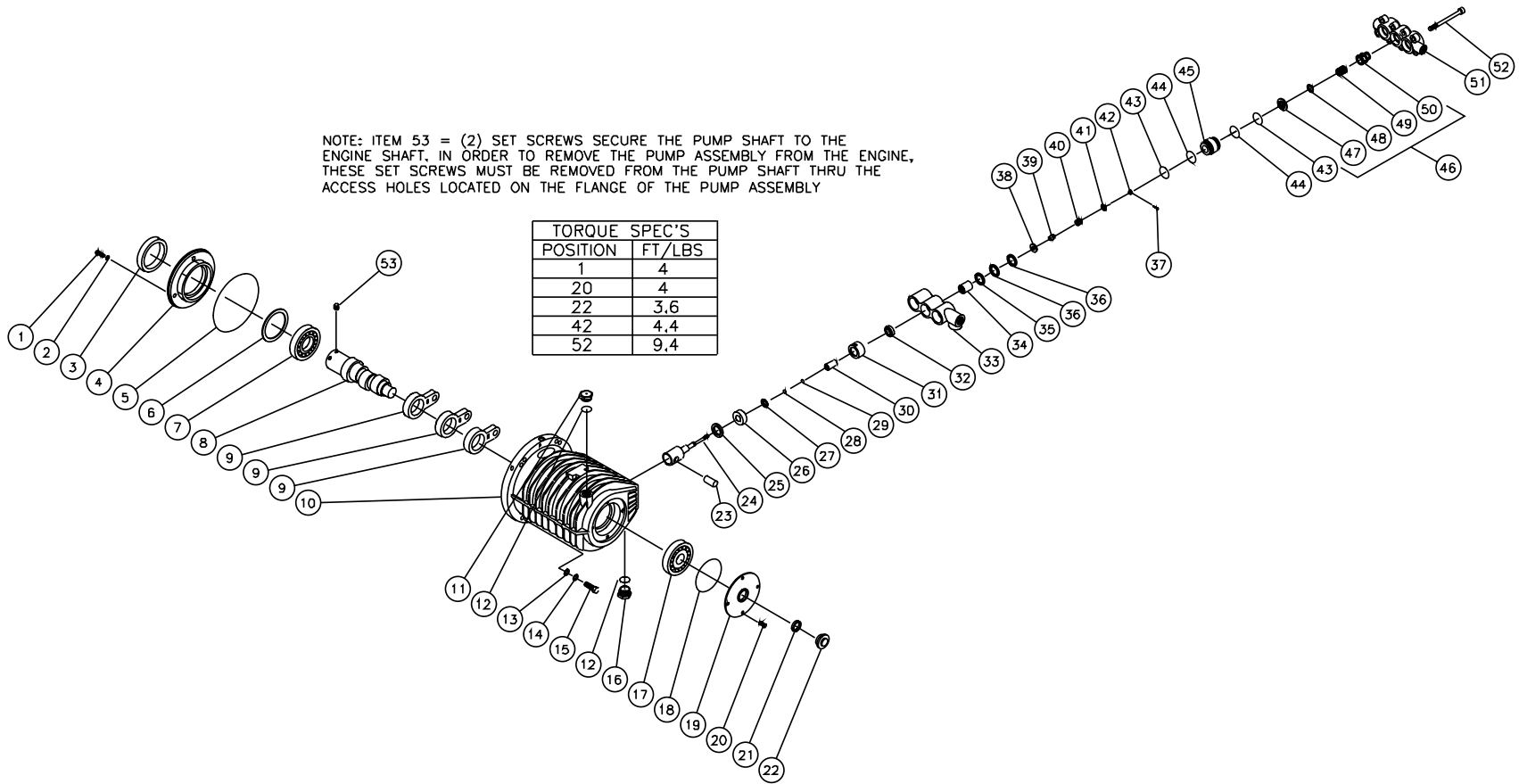

OMPMP024-051297-BAR

HIGH PRESSURE PUMP (3-0144)											
REF. #	DESCRIPTION	PART #	QTY.	REF. #	DESCRIPTION	PART #	QTY.	REF. #	DESCRIPTION	PART #	QTY.
1	Bolt	27-8380	4	20	Bolt	27-8381	4	39	Spacer (See 70-0173)	N/A Sep.	3
2	Washer	26-0159	4	21	Gasket	26-0139	1	40	Spring (See 70-0173)	N/A Sep.	3
3	Oil Seal	46-0538	1	22	Oil Sight Gauge	22-0123	1	41	Washer (See 70-0173)	N/A Sep.	3
4	Bearing Case	46-0498	1	23	Piston Pin	46-0502	3	42	Slotted Nut	46-0317	3
5	O-ring	25-0298	1	24	Piston Rod	46-0688	3	43	O-ring	25-0297	6
6	Washer	46-0499	1	25	Seal Washer	46-0484	3	44	Back-up Ring	25-0294	6
7	Bearing	46-0500	1	26	Oil Seal	46-0485	3	45	Spacer Adapter	46-0510	3
8	Crankshaft	46-0687	1	27	Washer	46-0689	3	46	Valve Assembly (Includes 47-50) (See 70-0174)	N/A Sep.	3
9	Connecting Rod	46-0521	3	28	Backup Ring	25-0378	3	47	Valve Seat (See 70-0174)	N/A Sep.	3
10	Crankcase	46-0497	1	29	Spacer Adapter	25-0377	3	48	Valve (See 70-0174)	N/A Sep.	3
11	Oil Fill Cap	46-0523	1	30	Sleeve	46-0690	3	49	Spring (See 70-0174)	N/A Sep.	3
12	O-ring	25-0199	2	31	Seal Retainer	46-0504	3	50	Valve Cage (See 70-0174)	N/A Sep.	3
13	Washer (See 70-0170)	N/A Sep.	4	32	Low Pressure Seal (See 70-0172)	N/A Sep.	3	51	Outlet Manifold	46-0511	1
14	Lockwasher (See 70-0170)	N/A Sep.	4	33	Inlet Manifold	46-0506	1	52	Cap Screw	46-0533	8
15	Bolt (See 70-0170)	N/A Sep.	4	34	Plunger	46-0528	3	53	Set Screw	27-8895	2
16	Oil Drain Plug	39-0057	1	35	Adapter- Female	46-0508	3		Bolt Mounting Kit (Includes 4 each 3-15)	70-0170	
17	Bearing	46-0501	1	36	V-packing (See 70-0172)	N/A Sep.	6		Seal Kit (Includes 3 each 32, 36-37, 43)	70-0172	
18	O-ring	25-0293	1	37	Cotterpin	43-0064	3		Inlet Valve Kit (Includes 3 each 37-41, 43)	70-0173	
19	Cover	46-0525	1	38	Inlet Valve (See 70-0173)	N/A Sep.	3		Valve Kit (Includes 3 each 43, 44, 47-50)	70-0174	